

FRONT ADJUST ARM INSTALLATION INSTRUCTIONS

OPTION 1

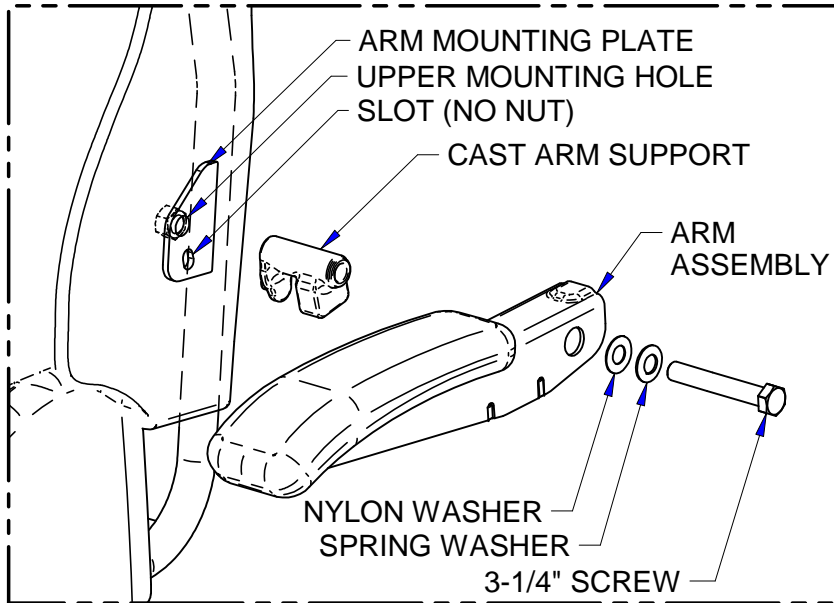

STEP 1: (LOCATING ARM PLATE)

LOCATE THE ARM MOUNTING PLATE BENEATH THE SEAT COVER BY FEELING ALONG THE SIDE OF THE BACK CUSHION.

STEP 2: (CUTTING OUT HOLES)

LOCATE THE UPPER MOUNTING HOLE IN THE ARM MOUNTING PLATE. USING A PAIR OF SCISSORS, PIERCE A HOLE THROUGH THE COVERING MATERIAL. LOCATE THE LOWER MOUNTING HOLE OR SLOT, APPROXIMATELY 1" DOWN FROM THE LARGER HOLE, AND PIERCE THE COVERING MATERIAL. CUT A SMALL PIECE OF FABRIC OUT OF EACH PIERCED HOLE FOR SCREWS TO PASS THROUGH.

STEP 3: (DETERMINE ARM OPTION)

IF THE ARM MOUNTING PLATE HAS A SLOT ON THE BOTTOM, FOLLOW OPTION 1. IF IT HAS A HOLE WITH A NUT ON THE BACK SIDE, FOLLOW OPTION 2. IF REPLACING EXISTING ARMS, FOLLOW OPTION 1 IF ARM SUPPORT IS A CAST PART OR OPTION 2 IF ARM SUPPORT IS A WELDMENT.

STEP 4a: (ATTACHING ARM FOR OPTION 1)

POSITION THE ARM ASSEMBLY ON THE ARM SUPPORT. PLACE THE SPRING WASHER, THEN THE NYLON WASHER, OVER THE 3-1/4" SCREW. INSERT 3-1/4" SCREW INTO THE BARREL OF THE ARM SUPPORT AND, **SLOWLY, PARTIALLY THREAD** INTO THE ARM MOUNTING PLATE. **ENSURE THAT THE PEG OF THE ARM SUPPORT IS FULLY INSERTED IN THE LOWER SLOT ON THE ARM PLATE**, THEN TIGHTEN SCREW AS TIGHT AS POSSIBLE.

STEP 4b: (ATTACHING ARM FOR OPTION 2)

POSITION THE ARM ASSEMBLY ON THE ARM SUPPORT. PLACE THE SPRING WASHER, THEN THE NYLON WASHER, OVER THE 3-1/4" SCREW. INSERT 3-1/4" SCREW INTO THE BARREL OF THE ARM SUPPORT AND **PARTIALLY THREAD** INTO THE ARM MOUNTING PLATE. THREAD THE 3/4" SCREW THROUGH THE LOWER ARM SUPPORT HOLE AND INTO THE ARM MOUNTING PLATE. FULLY TIGHTEN 3/4" SCREW. TIGHTEN 3-1/4" SCREW AS TIGHT AS POSSIBLE.

OPTION 2

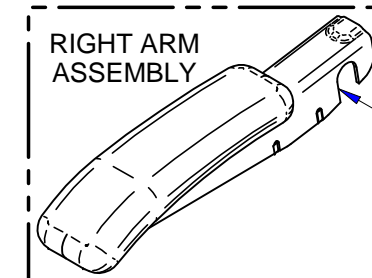
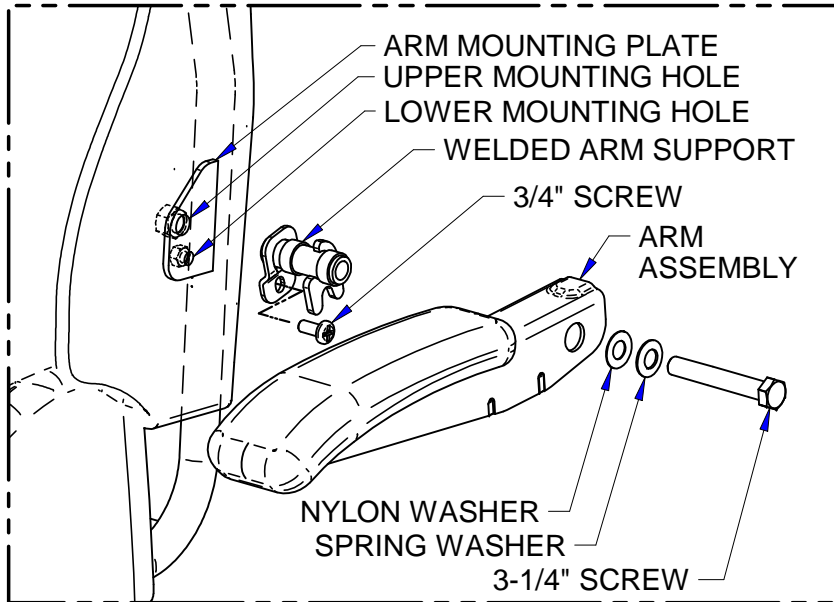

NOTE: LEFT ARM ASSEMBLY SHOWN. INSTALLATION IS SAME FOR RIGHT.

SEATS INCORPORATED ASSUMES NO RESPONSIBILITY FOR DAMAGE OR INJURY CAUSED BY IMPROPER SPACING TO VEHICLE CONTROLS OR INSTALLATION METHOD. THIS IS ONLY A GUIDELINE AND DOES NOT GUARANTEE SATISFACTORY SEAT FUNCTION DUE TO INCOMPLETE OR IMPROPER INSTALLATION. PARTS SUPPLIED BY SEATS INCORPORATED ARE COVERED BY A LIMITED WARRANTY.

seats

SIZE: A DRAWN BY: JCB

DATE: 04/15/09 REV. 04 DWG. NO. 702430

Seats Incorporated, 1515 Industrial St.
Reedsburg, WI 53959 (608) 524-4316
Fax: 608-524-6004
Toll Free: 1-800-443-0615