

kit arrache PDT

80 000 20 207

vis
bag
0300000025

Eléments
livrés séparément

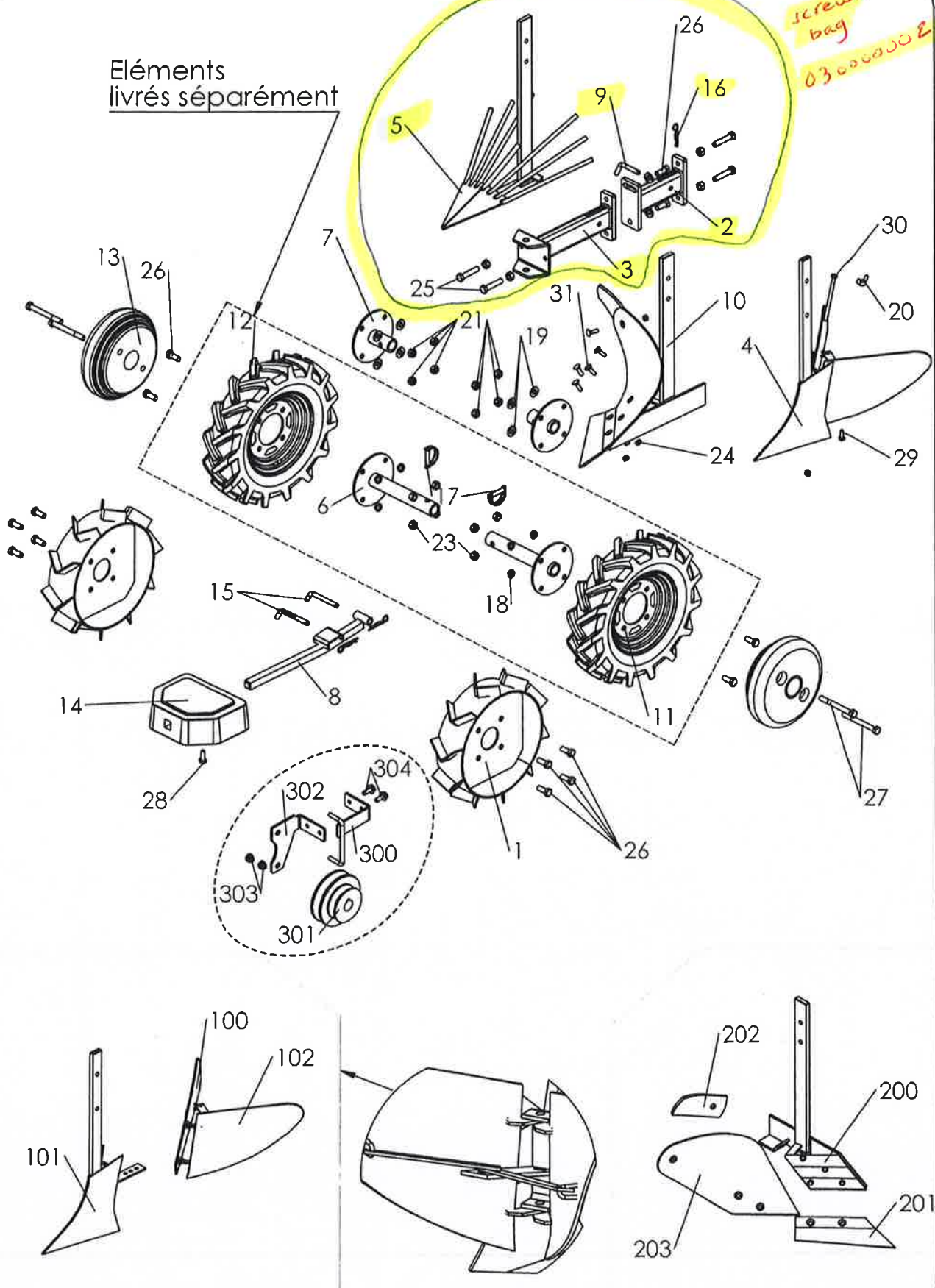

Rep N°	Ref.	Désignation	Description	Qte
1	8002011306	ROUE FER KIT BUTTAGE A0702 ROUGE RAL3002	Red RAL 3002 Iron wheel	2
2	8002010306	PERCHE ARR KIT A0703 xNOIRx	Black RAL 9005 back beam	1
3	8002010307	PERCHE AVT Quatro KIT A0704 NOIR RAL9005	Black RAL 9005 Quatro front beam	1
4	8001010002	Butteur Élançon Rouge [3002]	Red (3002) Ridger leg	1
5	8002011307	ARRACHE PDT KIT BUTT A0703 ROUGE RAL3002	Red RAL 3002 Potatoes puller	1
6	8003010008	MOYEU KIT ROUE NOIR 400x8 LG 230 PRIMO/ECO/PROMO	Black (9005) Wheel hub length 230mm	2
7	8002010304	MOYEU KIT ROUE LG 80 xNOIRx	Black RAL 9005 wheel hub kit length 80mm	2
8	3502010310	SUPP CONT. Pds AV1 QUATRO xNOIRx	Black Balance weight support	1
9	3002000105	BROCHE Ø10 LG 60	Pin Ø10 length 60	1
10	8001010001	CHARRUE SIMPLE 6"	Red RAL 3002 Plough 6"	1
11	0309000024	ROUE 4.00x8 GAUCHE PNEU 4PR KT801 ou DURO JANTE 2.50x8 4.8	LEFT WHEEL 400X8 (TIRE 4PR) KT801 ou DURO JANTE 2.50x8 4.8	1
12	0309000023	ROUE 4.00x8 DROITE PNEU 4PR KT801 ou DURO JANTE 2.50x8 4.8	RIGHT WHEEL 400X8 (TIRE 4PR) KT801 ou DURO JANTE 2.50x8 4.8	1
13	0303000021	MASSE ROUE 400x8	Grey (7000) Wheel balance weight	2
14	0303000002	CONTRE POIDS AVANT 20KG MDLE97	Front balance weight	1
15	0302020052	BROCHE ROUE TRANSPORT Ø10	PIN TRANSPORT WHEEL Ø10	2
16	0301030005	GOUPILLE BETA 2.5 Z x 60	Clip pin beta 2.5	3
17	0301010007	GOUPILLE CLIPS 45 X 10	Clip pin Ø10x45	2
18	0300451201	RONDELLE GROWER 12 Z	Grower washer M12	8
19	0300401201	RONDELLE PLATE M 12X27X2.5 Z NFE 25513	PLATE WASHER M 12X27X2.5 Z NFE 25513	10
20	0300240801	ECROU A OREILLES M 8 Z	Butterfly nut M8	1
21	0300211201	ECROU FREIN M 12 Z DIN 985/8	BLOCKING NUT M 12 Z	8
22	0300210802	ECROU FREIN M 8 Z DIN 985/8	BLOCKING NUT HM 8 Z DIN 985/8	1
23	0300201202	ECROU H.U. M 12 Z DIN 934-8	NUT HM 12Z	12
24	0300200801	ECROU H.U. M 8 N ISO 4032.8	Nut H M8	5
25	0300011218	VIS H FST 12X60 Z DIN 933/6.8	Screw HM 12x60z	4
26	0300011217	VIS H FST 12X30 N DIN 933/6.8	Screw HM 12x30z	14
27	0300011201	VIS H 12 X 110/30 Z CL 8.8 NFE 24024-ISO 4014	Screw H M 12x110/30 Z ISO4014	4
28	0300011008	VIS H 10 X25 Z DIN 933/8/8	Screw H M10x25 z	1
29	0300010806	VIS H 8 X 20 Z DIN 933 8/8	Screw HM 8x20 z	1
30	0300010805	VIS H 8 X 120/22 Z	Screw HM 8x12/220 z	1
31	0002070017	VIS 9x25 TETE FRAISEE COLLET CARRE	Screw TF collet carré 9x25 D608	5
100	8003010005	VERSOIR BUTTEUR PM DROIT ROUGE RAL3002	Red RAL 3002 Right ridger blade	1
101	8002011308	AV1 CORPS BUTTEUR KIT A0702 ROUGE RAL3002	Red RAL 3002 Front casing(ridger)	1
102	8003010006	VERSOIR BUTTEUR PM GAUCHE ROUGE RAL3002	Red RAL 3002 Left ridger blade	1
200	8002011310	CHARRUE KIT A0703 ROUGE RAL3002	Red RAL 3002 Welded plough	1
201	8002010308	SOC CHARRUE KIT A0703 NOIR RAL9005	Black RAL 9005 Blade	1
202	8002010309	OREILLE CHARRUE KIT A0703 NOIR RAL9005	Black RAL 9005 Aileron	1
203	8002011309	VERSOIR CHARRUE KIT A0703 ROUGE RAL3002	Red RAL 3002 Mouldboard	1
300	3502010206	Guide courroie adaptl Snow blade xQ Junior x7INGUEx	BELT GUIDE FOR DOUBLE PULLEY	1
301	0306060026	POULIE MOTEUR DOUBLE KIT SNOW BLADE	QUATRO DOUBLE PULLEY GROOVE	1
302	0304000270	SUPPORT GUIDE COUR SNOW BLADE	SUPPORT FOR DRIVE BELT SNOW BLADE	1
303	0300260601	ECROU HM 6 ZEMB CR DIN 6923	NUT H M6 Z NOTCHED SHOULDER	2
304	0300010609	VIS H 6x16 Z EMB CR DIN 6921	SCREW HM 6X16 Z NOTCHED SHOULDER	2